

## \_Control Ball Valves



**\_Made in Germany**



With more than 25 years of experience, TEC artec GmbH established a sophisticated Control Ball Valve Product Line, known as variTEC, with a special focus on optimized material selections as well as customized control characteristics.

TEC artec's variTEC - product line is engineer-ed for unique operational requirements and involves a strong collaboration between engineering, operations, maintenance and manufacturing.

**VARITEC IS PRIMARILY USED IN FOLLOWING INDUSTRIAL APPLICATIONS WITH A FOCUS ON SEVERE CONDITIONS:**



**\_VARITEC CONTROL BALL VALVE APPLICATIONS ARE PROVIDING VARIOUS TECHNICAL ADVANTAGES TO GLOBE- AND GATE VALVES:**

_variTEC	Globe Valve	Gate Valve
<b>Pressure assisted sealing</b>	Relies on vertical thrust by the stem to drive the sealing plug into seat	Torque seated to activate seal – thermal cycling relaxes stem seat
<b>Recessed seats are protected from continual exposure to the process flow</b>	Sealing components facing the flow directly, which leads to erosion	Erosion of sealings due to exposure when the valve is in open position
<b>Seat rings wiping and cleaning the ball with every operation</b>	Exposed sealing surface causes a loss of tightness with every operation	Sealing captures flow particles which are causing the development of erosion
<b>Minimal operation torque due to rotary operation movement</b>	Lifting operation movement causes higher operation torques which lead to more expensive as well as space requesting actuation requirements.	
<b>Non rising stem meets packing leakage standards for greater number of cycles</b>	A sliding stem valve will not provide the length of life expectation as well as number of operations	

**\_variTec Control Ball valves**

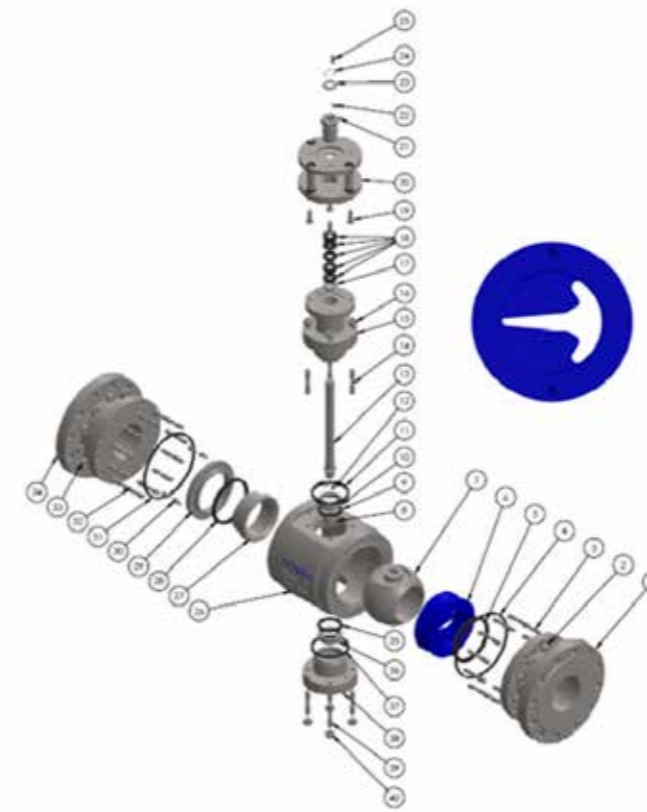

COMPONENTS	STANDARD MATERIALS	
	EN	ASTM
1 Body Flange	1.5415 / 16Mo3	ASTMA182F1
2 Nut	1.7264 / 20CrMo5	
3 Stud Bolt	1.7709 / 21CrMoV5-7	ASTMA193-B7
4 Seal Ring	Graphite	Graphite
5 Seal Ring	Graphite	Graphite
6 Regulation Disk	1.4122 / X39CrMo17-1	ASTMA276-420
7 Ball	1.4122 (1.4027) / X39CrMo17-1	ASTMA276-420
8 Bearing Bush	1.4541 / X6CrNiTi18-10	ASTM321
9 Stem Seal Ring	Graphite	Graphite
10 Stem Bearing	1.4641 / X6CrNiTi18-10	ASTM321
11 Seal Ring	Graphite	Graphite
12 Federkey	1.4641 / X6CrNiTi18-10	ASTM321
13 Stern	1.4122 / X39CrMo17-1	ASTMA276-420
14 Stud Bolt	1.7709 / 21CrMoV5-7	ASTMA193-B7
15 Pecking Housing	1.5415 / 16Mo3	ASTMA182F1
16 Nut	1.7264 / 20CrMo5	
17 Base Ring	1.4641 / X6CrNiTi18-10	ASTM321
18 Seal Ring	Graphite	Graphite
19 Hexagonal Bolt	A2-80	ASTM304
20 Mounting Bracket	1.0037 / S235JR (St37-2)	
21 Thrust Piece	1.4641 / X6CrNiTi18-10	
22 Pointer	10050 / E292	
23 Washer	1.4571 / X6CrNiMoTi17-12-2	
24 Safety Ring	Spring Steel	
25 Federkey	1.0050 / E295	
26 Housing	1.5415 / 16Mo3	ASTMA182F1
27 Seal Ring	Graphite	Graphite
28 Seal Ring	Graphite	Graphite
29 Thrust Ring	1.4122 (1.4027) / X39CrMo17-1	ASTMA276-420
30 Hex Socket Bolt	A2-80	
31 Seal Ring	Graphite	Graphite
32 Stud Bolt	1.7709 / 21CrMoV5-7	ASTMA193-B7
33 Nut	1.7264 / 20CrMo5	
34 Body Flange	1.5415 / 16Mo3	ASTMA182F1
35 Seal Ring	Graphite	Graphite
36 Trunnion Bushing	1.4641 / X6CrNiTi18-10	ASTMA182F1
37 Seal Ring	Graphite	Graphite
38 Trunnion Flange	1.5415 / 16Mo3	ASTMA182F1
39 Stud Bolt	1.7709 / 21CrMoV5-7	ASTMA193-B7
40 Nut	1.7264 / 20CrMo5	

**GENERAL CHARACTERISTICS OF VARITEC PRODUCT LINE:**

CHARACTERISTICS		OPTIONAL:	
	Shut-off Valve	Control Valve	
<b>Size</b>	NPS 4" – 56" DN 100 – 1400	NPS 1" – 56" DN 25 – 1400	<b>Design options</b> Split Body design Three Piece Design / Two Piece Design  - material selection according to medium (e.g. stainless steel, Halar®, ceramic components, tungsten carbide coating, plasma nitriding)  Sealing system - Metal-Metal / Soft / PMSS (primary metal secondary soft) - single- or double-piston effect - double-block-and-bleed  - bypass system according to customer requirements - additional air vent - additional drain  - unidirectional or bidirectional flow analysis  - emergency shut-off design
<b>Pressure</b>	Class 600 – 2500 PN 100 – PN420	Class 300 – 2500 PN 63 – PN420	
<b>Temperature range</b>	°F 14 – 788 °C -10 – 420		
<b>Work principle</b>	Shut-off function Control function Linear Control / Equal Percentage Control 1-step / 2-step pressure regulation		
<b>General design</b>	- Multi-piece-body design - Trunnion mounted - forged steel for pressure carrying components - design according to EN or ASME standards - Anti-Blowout Stem - variable interface according to ISO 5210		<b>Actuator options</b> - bare stem - pneumatic actuation - electric actuation - hydraulic actuation - hand wheel + gearing

# \_Geared For the Future



## A PART OF SOMETHING BIGGER

With the membership of the AVK Group, the company has a strategic partner with which we market our high quality and innovative products worldwide and use the synergies of the group in the sales and purchasing areas. The AVK Group, with its more than 77 companies worldwide, is supplying more than 80 countries with products and services via own sales companies, agents, distributors and license holders. This global network permits close cooperation with our customers and end users, ensuring a high level of service and customer satisfaction.net sales of more than 500 million Euro.

## MEET OUR CUSTOMERS

SIEMENS

ALSTOM



posco

SAMSUNG SAMSUNG ENGINEERING

## CONTACT DETAILS



### SALES

Robert Stein  
+49 (0)3301203261  
robert.stein@tec-artec.de

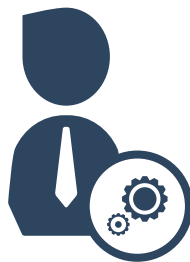

### SPARE PARTS REQUESTS

Axel Zimmermann  
+49 (0)3301203276  
axel.zimmermann@tec-artec.de



### PURCHASE

Sebastian Ellinger  
+49 (0)3301203262  
sebastian.ellinger@tec-artec.de



### TECHNICAL QUESTIONS

Kay Fugmann  
+49 (0)3301203275  
kay.fugmann@tec-artec.de



TEC artec GmbH  
Am Heidering 7aD  
16515 Oranienburg  
+493301/2032-60

[www.tec-artec.de](http://www.tec-artec.de)  
info@tec-artec.de